

# SMART LIVING 24 - SPACE CAPSULE CATALOG 2025

SMART LIVING 24  
Mob/Whatsapp/Wechat:+47 400 33335  
[www.smartliving24.no](http://www.smartliving24.no)  
[post@smartliving24.no](mailto:post@smartliving24.no)

The image shows three futuristic space capsule houses on a grassy hill at night. The central capsule is white with large windows and a glowing blue light strip along its edges. It has a small set of stairs leading to its entrance. To the left, another capsule is partially visible, showing an interior with orange seating. To the right, a third capsule is shown from a different angle. The background is a dark sky with stars and a faint Milky Way, suggesting a high-altitude or outdoor setting.

# SPACE CAPSULE HOUSE

Breaking free from the constraints of traditional architectural space, creating a personalized and luxurious lifestyle that is infinitely close to nature, and enjoying a new journey experience

## ▶ Production

Production is a technology-based enterprise that integrates the research and development, production, and sales of spacecraft, aiming to provide cutting-edge technology, cultural and tourism housing for our customers.

With years of experience in the production and manufacturing of aluminum profiles and stainless steel materials, have become an important force in promoting the development of the cultural and tourism prefabricated construction industry.

Producer have two major factory areas with a total area of approximately 50,000 square meters, and more than 200 standard production machines. The monthly delivery volume can reach over 200 units. The R&D, production, and quality control teams all have over fifteen years of experience in the industry.

The company mainly develops and produces new generation spacecraft, prefabricated buildings, modular homestays, triangular houses and other cultural and tourism products. We provide one-stop services for the design, manufacturing, and installation of cultural and tourism homestays, which are widely used in various scenarios such as hotels, scenic spots, and themed homestays.



# ▶ PRODUCT ADVANTAGES

## Unrestricted terrain ecological development

No foundation, all terrain of peak, dense forest and mudflat is covered, no vegetation is damaged, no construction waste, and ecological and environmental protection



## Rapid landing of prefabricated houses

30 days of production in the workshop, integrated into the entire house for 2 hours and ready to use on the ground, without the need for on-site construction and decoration

## Internet celebrity check-in to attract attention and attract traffic

Internet celebrity check-in, 24/7 release, perfect integration of technology and culture and nature, and product with built-in fan traffic



## Panoramic View Returns to Nature

270 ° panoramic french window, thermal insulation, sleeping in the scenery, enjoying pure natural fun

## ▶ PRODUCT ANALYSIS

Modern minimalist style, equipped with smart appliances throughout the house, with a layout of two bedrooms, one living room, one bathroom, and one balcony space.

The body is made of fluorocarbon process aluminum alloy, which is moisture-proof, anti-corrosion, rust resistant, earthquake resistant, and windproof.

The overall structure is made of seismic resistant steel, with bottom screws fixed for seismic resistance of level 9. The entire warehouse can withstand level 12 typhoons, making it sturdy and durable.

Wall covering with thermal insulation materials effectively reduces the impact of temperature changes.

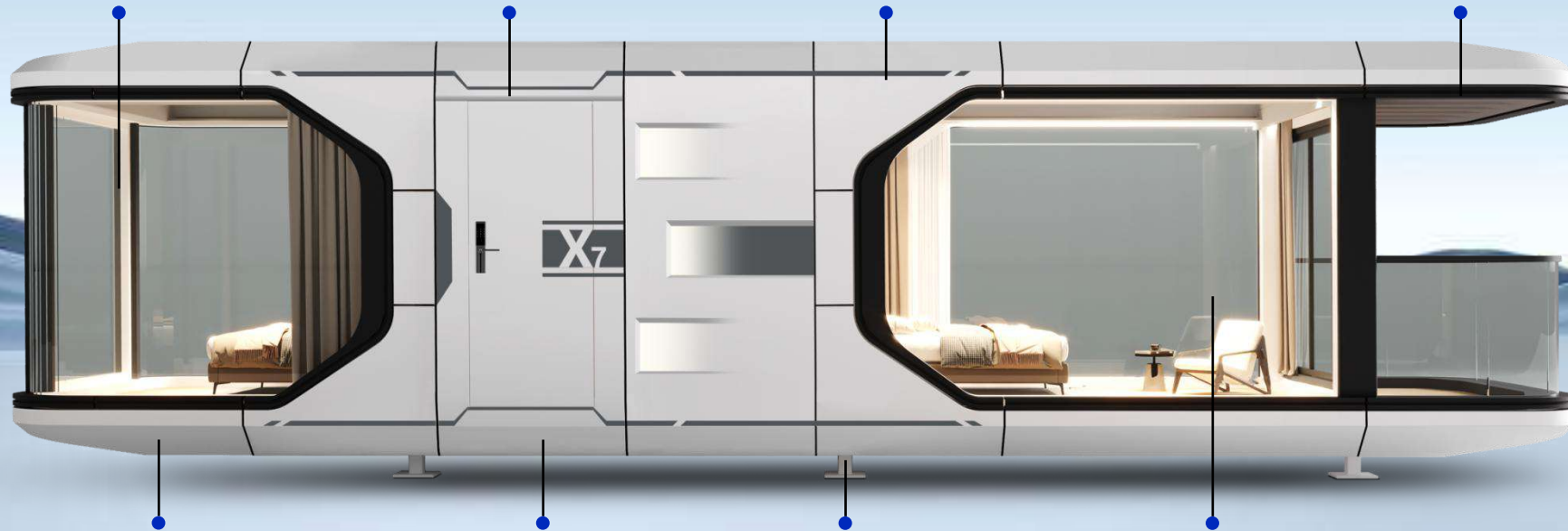

The main framework is independently developed and adopts a hot-dip galvanized steel structure, which is sturdy and durable for over 50 years.

Ecological and environmentally friendly, complete and dismantled without destroying any plants or trees.

Equipped with foot support, not limited by terrain, deep into the hinterland of the scenic area.

L type french window adopts new building material, double-layer hollow Low-e glass, which has excellent heat insulation performance and high light transmittance, heat insulation and sound insulation.

# ▶ PRODUCT CATALOGUE

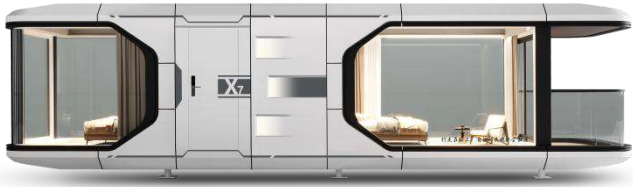

## X7

**2 bedroom-1 bathroom-1 balcony**

Size: 11.5 X 3.3 X 3.2m / 37.7 X 10.8 X 10.5ft

Area: 38m<sup>2</sup> / 409ft<sup>2</sup>

Accommodate : 4-6 people

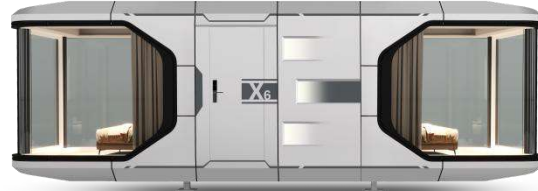

## X6

**2 bedroom-1 bathroom**

Size: 9.5 X 3.3 X 3.2m / 31.2 X 10.8 X 10.5ft

Area: 31m<sup>2</sup> / 333.7ft<sup>2</sup>

Accommodate : 3-4 people



## X5

**1 bedroom-1 bathroom-1 balcony**

Size: 8.5 X 3.3 X 3.2m / 27.9 X 10.8 X 10.5ft

Area: 28m<sup>2</sup> / 301.4ft<sup>2</sup>

Accommodate : 2 people



## X3

**1 bedroom-1 bathroom**

Size: 5.6 X 3.3 X 3.2m / 18.4 X 10.8 X 10.5ft

Area: 18m<sup>2</sup> / 193.8ft<sup>2</sup>

Accommodate : 2 people



## P7

**1 bedroom-1 bathroom-1 living room**

Size: 11.5 X 3.3 X 3.2m / 37.7 X 10.8 X 10.5ft

Area: 38m<sup>2</sup> / 409ft<sup>2</sup>

Accommodate : 4-6 people



## P5

**1 bedroom-1 bathroom-1 living room**

Size: 9.5 X 3.3 X 3.2m / 31.2 X 10.8 X 10.5ft

Area: 31m<sup>2</sup> / 333.7ft<sup>2</sup>

Accommodate : 3-4 people



## P3

**1 bedroom-1 bathroom**

Size: 5.6 X 2.8 X 3m / 18.4 X 9.2 X 9.8ft

Area: 16m<sup>2</sup> / 172.2ft<sup>2</sup>

Accommodate : 2 people



## V6

**1 bedroom-1 bathroom-1 living room**

Size: F1-5.5 X 4 X 2.5m / 18 X 13.1 X 8.2ft

F2-5.5 X 2.6 X 2.5m / 18 X 8.5 X 8.2ft

Area: F1-20.3m<sup>2</sup> / 218.5ft<sup>2</sup> F2-12.5m<sup>2</sup> / 134.5ft<sup>2</sup>

Accommodate : 2 people

## ▶ CONFIGURATION CHECKLIST

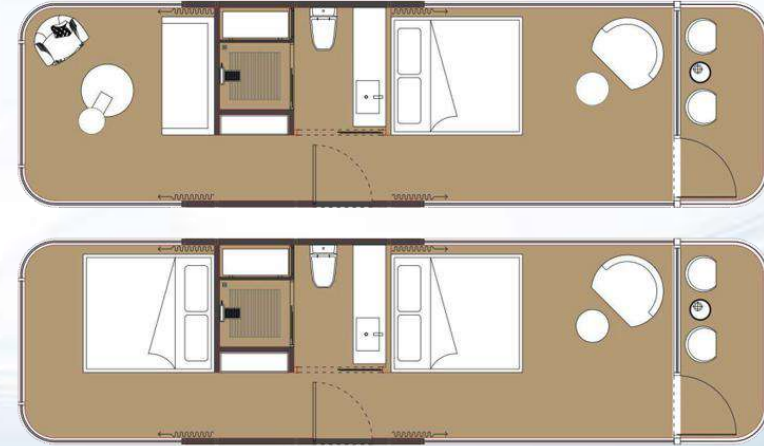
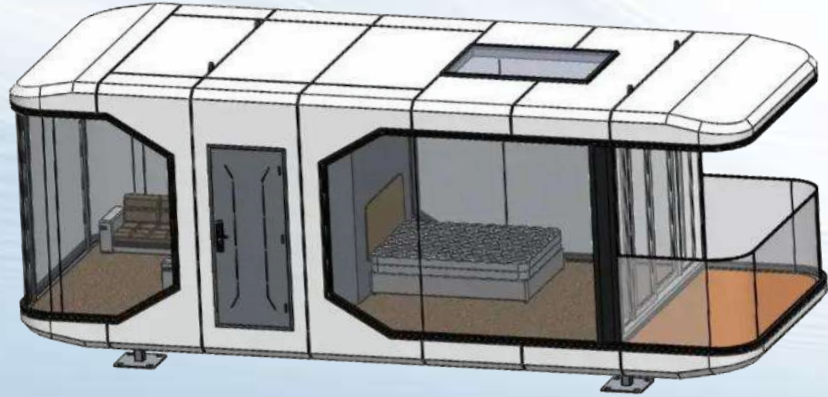

### Peripheral guardrail system

- Galvanized steel structural framework system
- Fluorocarbon sprayed aluminum alloy housing module
- Thermal insulation, waterproof and moisture-proof structural system
- Hollow tempered glass doors and windows
- Hollow laminated tempered glass skylight
- Standard entrance door
- Panoramic balcony

室内精装

### Customer control system

- Card insertion power/card retrieval power off panel
- Multi scenario mode function panel lighting
- Intelligent integrated control of lighting/curtains
- Whole house intelligent voice control

### Interior decoration

- Standard color aluminum panel ceiling
- Environmentally friendly SPC flooring
- Bathroom privacy glass door
- Toilet marble/ceramic tile flooring
- Customized sink/basin/bathroom mirror
- Toilet/faucet/flower wine
- Whole house lighting system
- Whole house water and electricity system
- Midea variable frequency heating and cooling air conditioning
- Integrated water heater
- Electric curtain track
- Electric sunroof sunshade

### Luxury version configuration(optional)

- Standard Entry Welcome Stair Landing
- Indoor Intelligent Blackout Curtains
- Whole House Background Music System
- Projection equipment system/TV
- Wall double insulation structure
- Electro-assisted Underfloor Heating
- Intelligent Toilet
- Bed
- Bedside table
- Closet
- Kitchen System

## ▶ X7 CAPSULE HOUSE

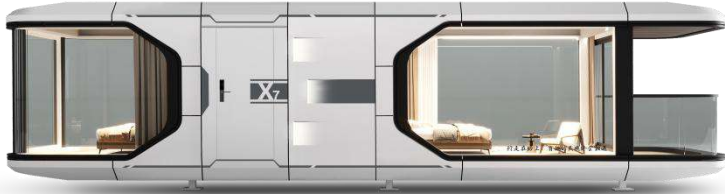

**Size: 11.5 X 3.3 X 3.2m / 37.7 X 10.8 X 10.5ft**

**Area: 38m<sup>2</sup> / 409ft<sup>2</sup>**

**Accommodate : 4-6 people**

**Total power consumption: 15KW**

**Weight: 9 tons**

The X7 capsule is by far the most popular and best-selling product. The use of black and white duality to enhance the visual effect, the smooth and rigid design lines, the 270-degree views plus a skylight, the spacious viewing balconies, the separate wet and dry bathrooms, the large wide sinks, and the ability to blend in with nature while transcending it, are all reasons why it has become a hot seller.



2 bedroom-1 bathroom-1 balcony



1 bedroom-1 living room-1 bathroom-1 balcony



## ▶ X6 CAPSULE HOUSE

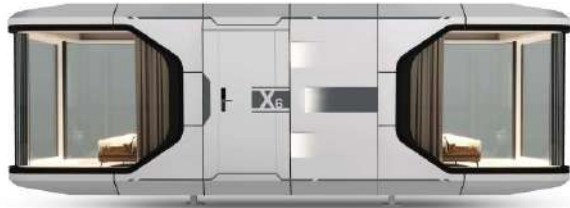

**Size: 9.5 X 3.3 X 3.2m / 31.2 X 10.8 X 10.5ft**

**Area: 31m<sup>2</sup> / 333.7ft<sup>2</sup>**

**Accommodate : 3-4 people**

**Total power consumption: 15KW**

**Weight: 8 tons**

The X6 capsule is full of sci-fi space capsule design, combined with our unique original style, clean lines and atmosphere, the interior follows the standard hotel bed layout, wet and dry separation of independent bathroom, 270° "landscape window, private balcony, can easily accommodate 2-4 people, to meet the needs of the young people nowadays, to enjoy the fun of the outdoor campsite.

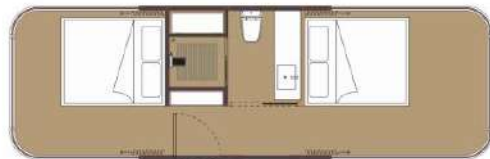

2 bedroom-1 bathroom

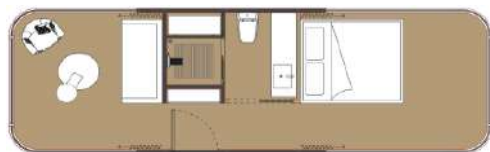

1 bedroom-1 living room-1 bathroom





## ▶ X5 CAPSULE HOUSE



**Size: 8.5 X 3.3 X 3.2m / 27.9 X 10.8 X 10.5ft**

**Area: 28m<sup>2</sup> / 301.4ft<sup>2</sup>**

**Accommodate : 2 people**

**Total power consumption: 10KW**

**Weight: 7 tons**

The X5 capsule continues the design style and creative inspiration of the X7, and has its own unique charm, with separate wet and dry bathrooms, large floor-to-ceiling windows, and a large interior space of 28 square meters, which is matched with a whole-house intelligent control system, making it more technological and fashionable.

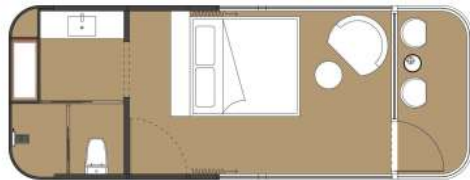

1 bedroom-1 bathroom-1 balcony



## ▶ X3 CAPSULE HOUSE



**Size: 5.6 X 3.3 X 3.2m / 18.4 X 10.8 X 10.5ft**

**Area: 18m<sup>2</sup> / 193.8ft<sup>2</sup>**

**Accommodate : 2 people**

**Total power consumption: 6KW**

**Weight: 4 tons**

The most popular X3 single room , with separate wet and dry bathrooms, has an exterior design that blends well with nature, and the overall frame design is minimalist, with a traditional and efficient layout that makes it suitable for many scenarios.

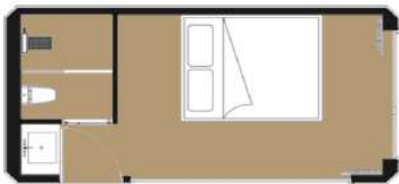

1 bedroom-1 bathroom



## ▶ P7 CAPSULE HOUSE



**Size: 11.5 X 3.3 X 3.2m / 37.7 X 10.8 X 10.5ft**

**Area: 38m<sup>2</sup> / 409ft<sup>2</sup>**

**Accommodate : 4-6 people**

**Total power consumption: 15KW**

**Weight: 7 tons**

The cool gray exterior of the P7 capsule blends in with nature, and the corners of the capsule are designed with eco-linear design techniques, while the overall frame flow is simple and clear, with a more technological sense. The space utilization rate is the highest among the existing series, with a high price/performance ratio!.

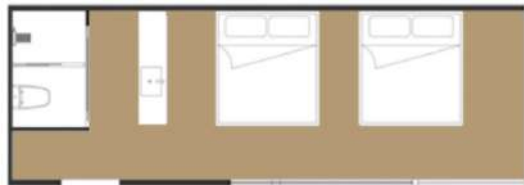

1 bedroom-1 living room-1 bathroom

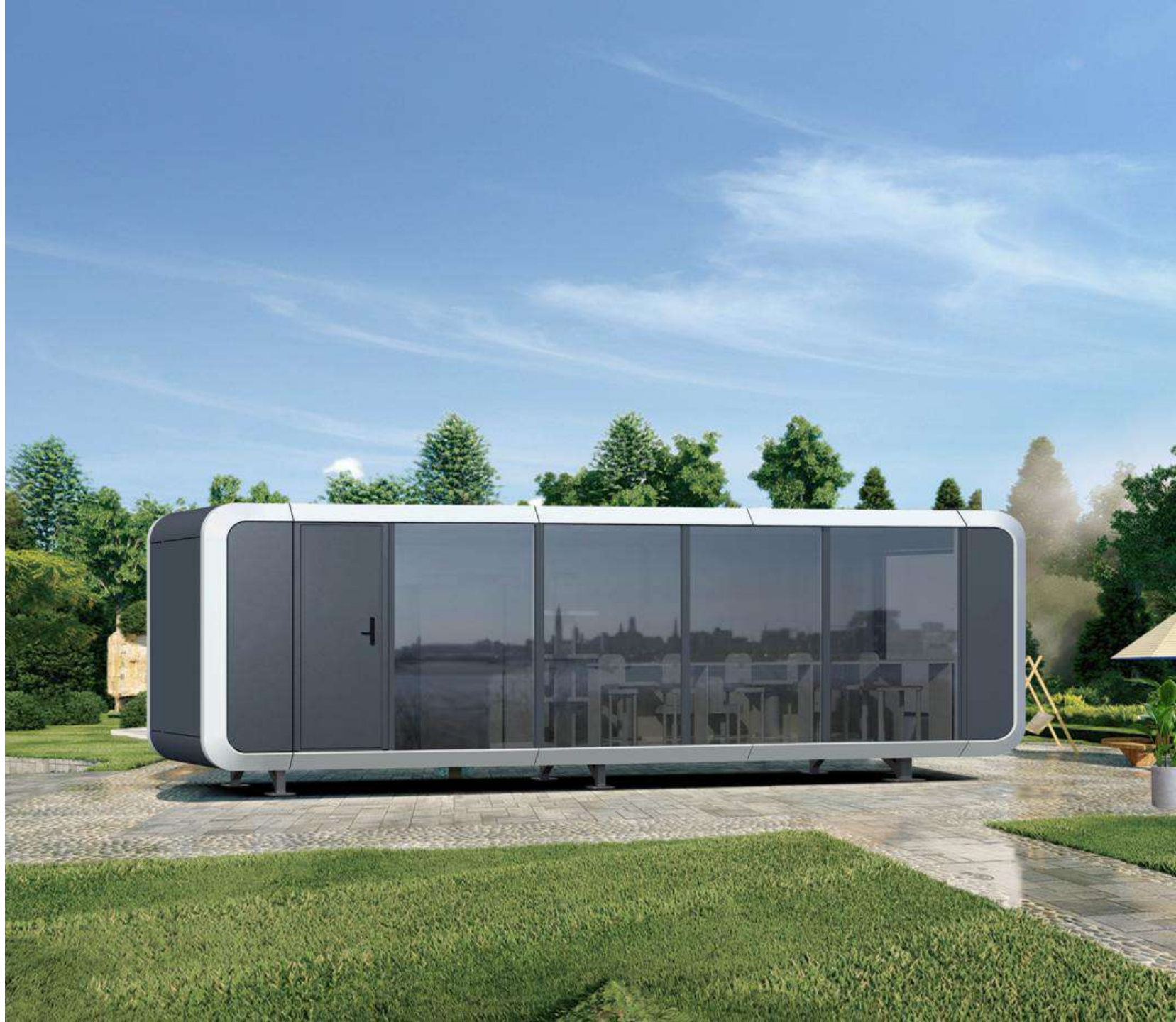

## ▶ P5 CAPSULE HOUSE



**Size: 9.5 X 3.3 X 3.2m / 31.2 X 10.8 X 10.5ft**

**Area: 31m<sup>2</sup> / 333.7ft<sup>2</sup>**

**Accommodate : 3-4 people**

**Total power consumption: 10KW**

**Weight: 6.5 tons**

The P5 capsule dark black tones increase its integration with the surrounding landscape, and the corners are designed using ecological line guarding techniques, so that the overall framework flow is simple and clear, with a greater sense of technology. High price-to-value ratio!

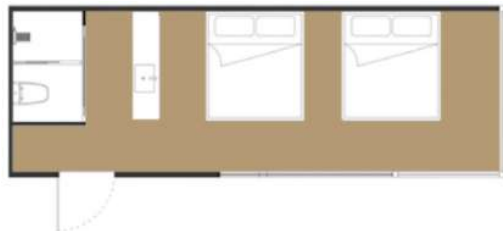

1 bedroom-1 living room-1 bathroom



## ▶ P3 CAPSULE HOUSE



**Size: 5.6 X 2.8 X 3m / 18.4 X 9.2 X 9.8ft**

**Area: 16m<sup>2</sup> / 172.2ft<sup>2</sup>**

**Accommodate : 2 people**

**Total power consumption: 10KW**

**Weight: 5 tons**

The most popular single room in the P3 capsule, with separate wet and dry bathrooms, the overall frame design is minimalist, with a traditional yet efficient layout, making it suitable for many scenarios.

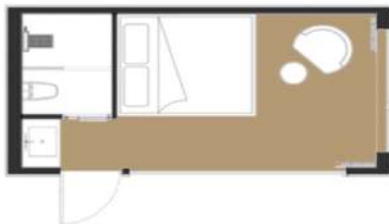

1 bedroom-1 bathroom



## ▶ V6 TRIANGLE HOUSE



**Size:** F1-5.5 X 4 X 2.5m / 18 X 13.1 X 8.2ft  
F2-5.5 X 2.6 X 2.5m / 18 X 8.5 X 8.2ft  
**Area:** F1-20.3m<sup>2</sup> / 218.5ft<sup>2</sup> F2-12.5m<sup>2</sup> / 134.5ft<sup>2</sup>  
**Accommodate :** 2 people  
**Total power consumption:** 10KW  
**Weight:** 5 tons

V6 triangular appearance of two-story design, very modern sense of technology, is a collection of close to the sense of nature experience, intelligent design concepts, modern intelligent control and green environmental protection of the new high-tech home.



1 bedroom-1 living room-1 bathroom



## ▶ INTERIOR DISPLAY



## ▶ INTELLIGENT SYSTEM





## ▶ SPACE CAPSULE HOUSE SKELETON STRUCTURE

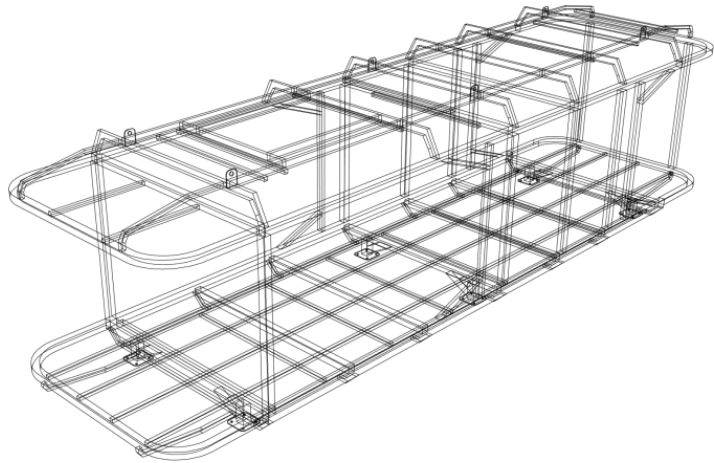

The entire interior of the cabin is welded with galvanized steel frame, which has high strength and is sturdy and durable for more than 50 years.

All steel is cut by laser and automatically welded by robots, with high accuracy and strong earthquake resistance and typhoon resistance

It can withstand various harsh weather conditions, is moisture-proof, corrosion-resistant, fire-resistant, soundproof, and heat-insulating, and is durable.



## ▶ DOUBLE LAYERED HOLLOW LOW-E GLASS

The contribution of Low-E glass to energy conservation is reflected in two aspects: on the one hand, Low-E film can reduce the heat exchange between the glass surface and the air, reducing the heat transfer caused by temperature difference on both sides of the glass (i.e. temperature difference heat transfer), which will reduce the temperature difference heat transfer of the glass; On the other hand, the Low-E film can effectively reflect solar radiation, thereby limiting the radiation heat energy (i.e. radiation heat transfer) that passes through the glass due to solar radiation, thereby reducing the solar heat energy passing through the glass.

Compared with ordinary glass and traditional architectural coated glass, its coating layer has excellent thermal insulation effect and good transparency.

The double-layer glass is internally filled with argon gas technology, which is more soundproof and waterproof.

Shield infrared thermal energy and filter sunlight into a light source.

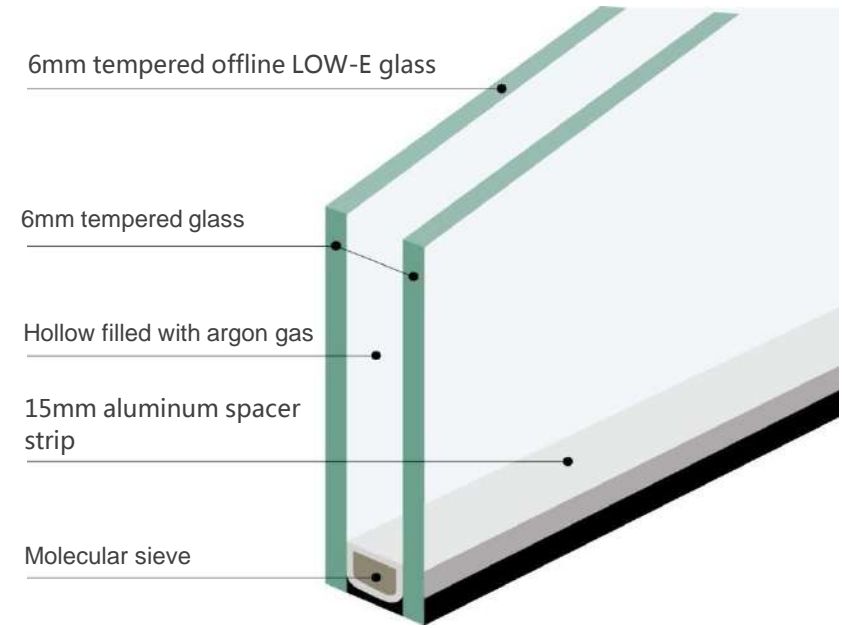
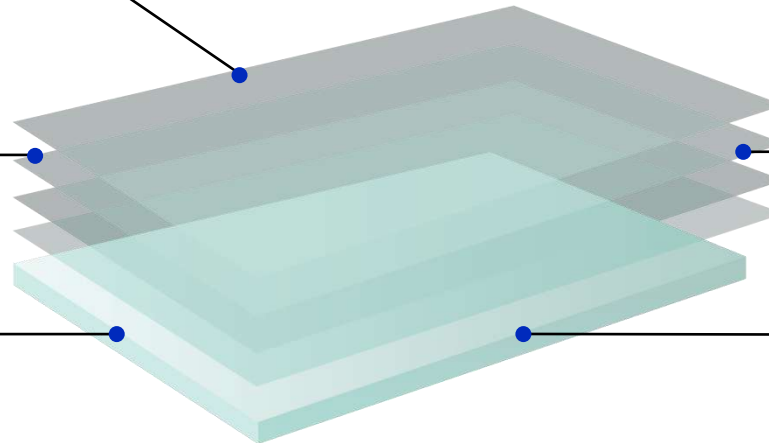

Actively blocking heat, effectively isolating indoor and outdoor heat conduction, Significantly enhance the thermal insulation performance of the entire window.

Automotive grade tempered glass. Safe and stress resistant, not afraid of typhoons

## ▶ ALUMINUM VENEER STRUCTURE

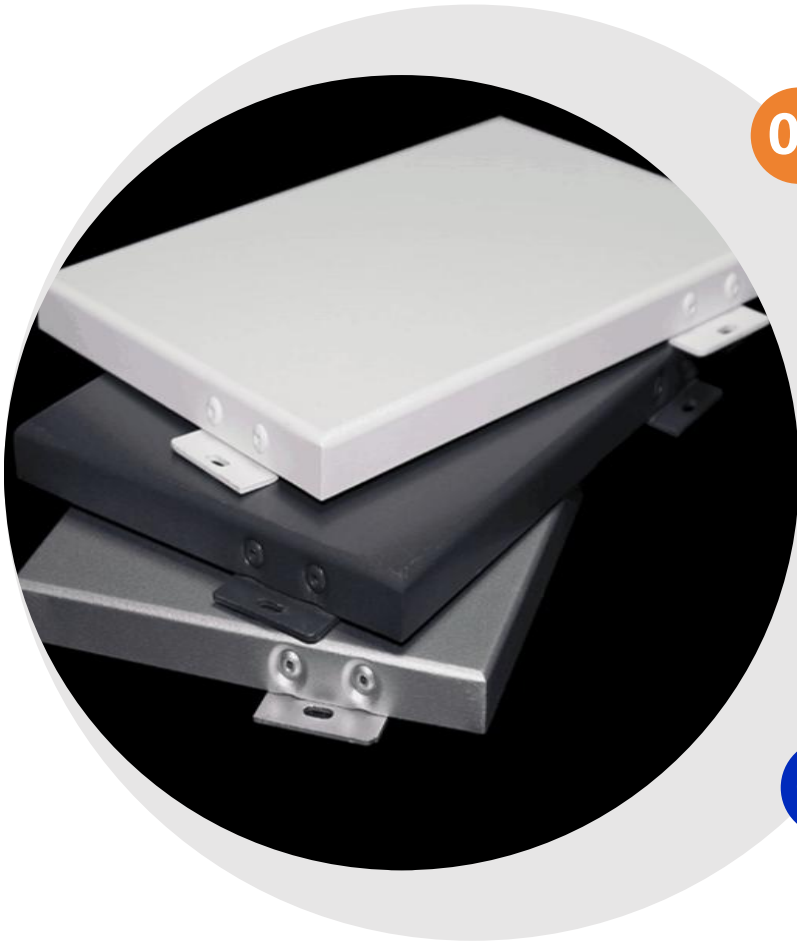

01

Longer lifespan: Stable product quality, consistent quality for 20 years, fluorocarbon aluminum veneer is sturdy and durable, with a long service life

02

Good performance: The surface is sprayed with fluorocarbon paint, which is not affected by ultraviolet rays, temperature, air temperature, and atmospheric erosion. The fluorocarbon aluminum veneer has good bending and wind pressure resistance performance

03

Reliable quality: National standard accessories, good light steel quality, high strength, and not easily deformed

04

Safety and Environmental Protection: Safe and formaldehyde free, strictly certified by the national environmental management system, recyclable and reusable

# ▶ CONSTRUCTION MATERIAL DISPLAY



Aluminum plate

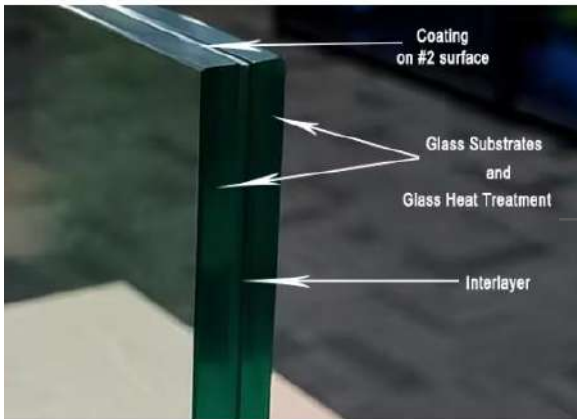

Reinforced glass



Reinforced glass



Floor

# ▶ AIR CONDITIONING SYSTEM

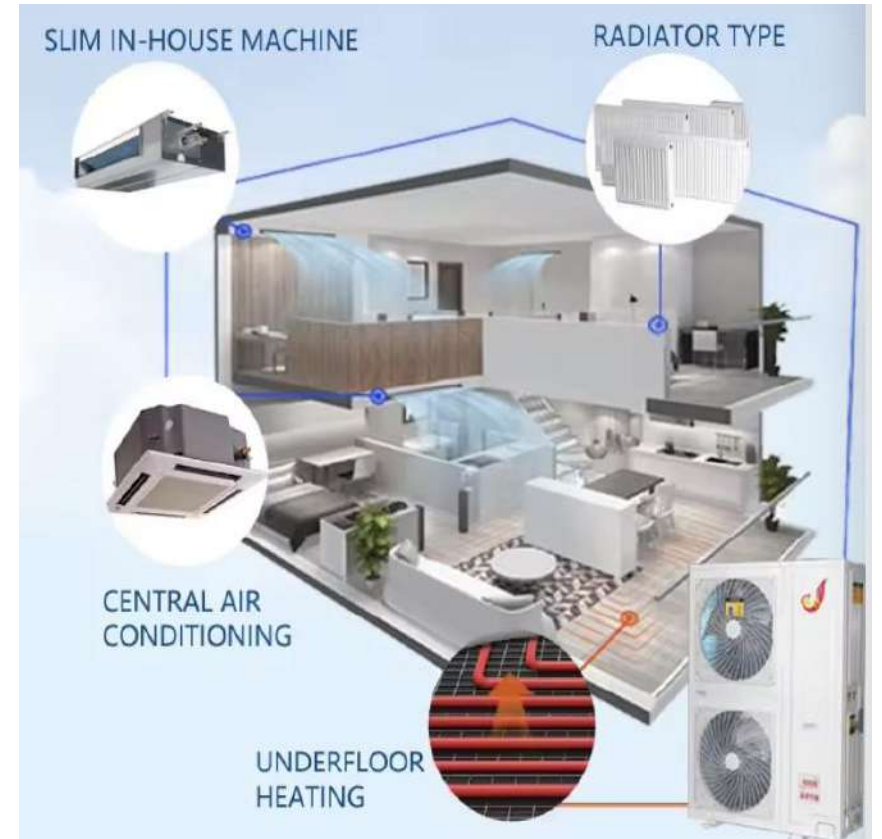
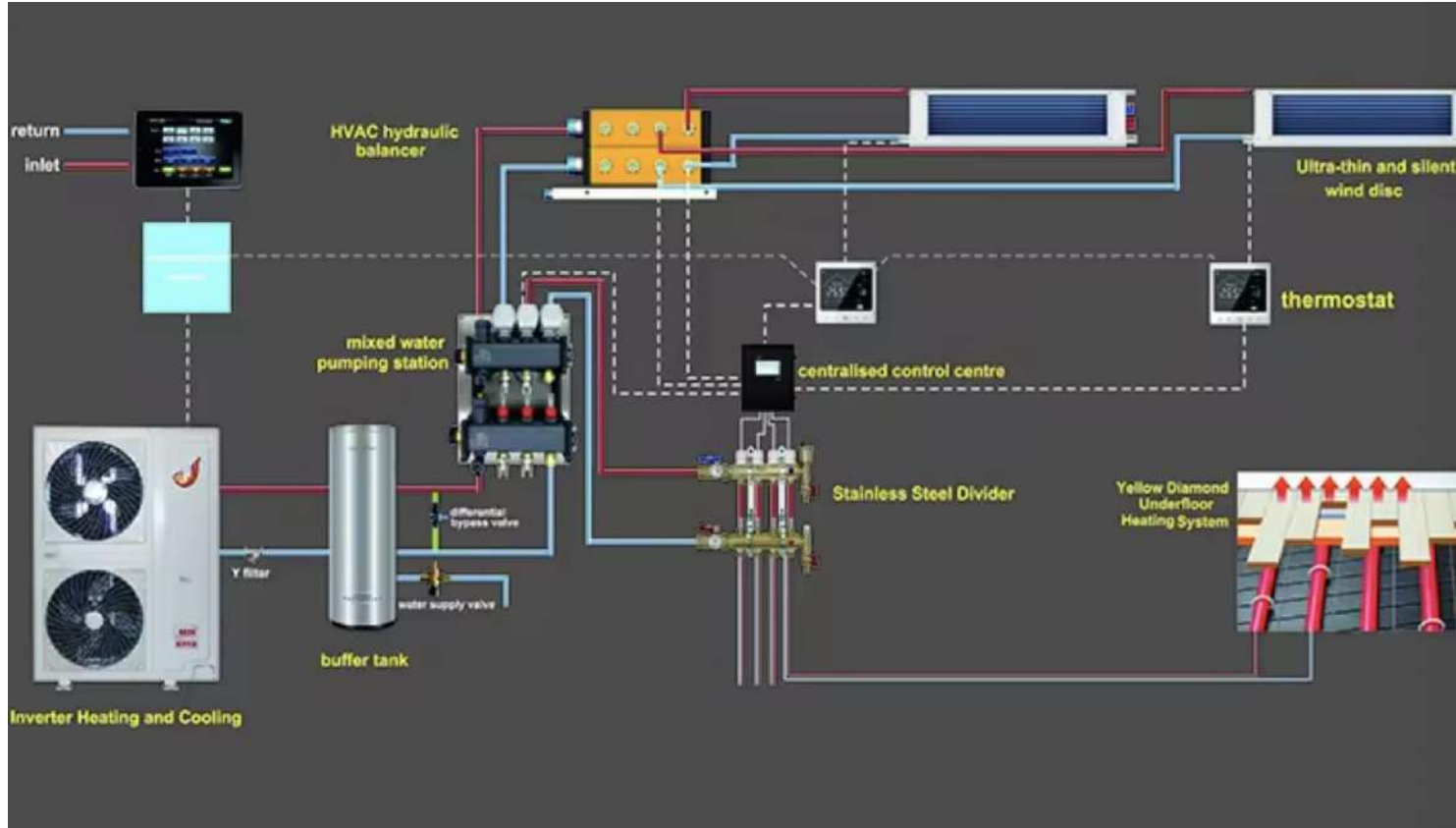

## ▶ SUPPLIER SYSTEM



# ▶ PRODUCT CASES-MOUNTAIN

Breaking the constraints of traditional architectural space and creating a personalized wild luxury lifestyle  
Unlimited closeness to nature, enjoying a new journey experience



# ▶ PRODUCT CASES-CAMPSITE

Space capsule house, with a minimalist futuristic style as its main focus Remove complex materials and line stacking To outline the beauty of nature with minimalist lines





# ▶ PRODUCT CASES-ISLAND

Experience a Different Travel Life

A new way of living a better life, leading the trend of high-end campsite market



## ▶ APPLICABLE SCENARIOS

Suitable for: rural revitalization, camping accommodation, outdoor markets, study tours, health care and elderly care, real estate, hotel catering, team building and expansion, and other scenarios.

### 01 Camp mode

Assist in the development of new models such as farms, ranches, and ecological parks, and equip them with new cultural and tourism campsites.



### 02 Hotel mode

Explore the travel ecosystem and create unique tourist accommodation destinations.

### 03 Integrated

Combining homestays with rural activities to create a one-stop project of "eating, drinking, playing, and learning".



### 04 Travel mode

Build a tourism base through natural resources such as forest health, hot spring vacations, and beach and sea views.

## ▶ TRANSPORTATION AND INSTALLATION



### 01 Transportation phase

The standard truck is a 13.5-meter-long semi-trailer with a transport width of 3m and a transport height of no more than 4.2m, which can be freely used on highways throughout the country.

### 02 Lifting stage

After the goods arrive at the site, the customer needs to contact the local crane service on their own. The lifting weight of the product ranges from 6 to 10 tons, and it is recommended to use a crane of no less than 25 tons for loading and unloading.

### 03 Installation phase

Under the guidance of our technicians, we completed the on-site engineering of water supply, power supply, sewage pipelines and load-bearing foundations, accurately positioned them at the designed installation points, connected the water and electricity, completed the water and electricity testing, and submitted them to the customer for acceptance.

SMART LIVING 24  
Mob/Whatsapp/Wechat:+47 400 33335  
[www.smartliving24.no](http://www.smartliving24.no)  
[post@smartliving24.no](mailto:post@smartliving24.no)

**THANK YOU FOR  
WATCHING !**

